

AN INTRODUCTION TO BERMUDA'S **Historic Cemeteries**



TEACHER RESOURCE GUIDE



ACKNOWLEDGEMENTS

The Bermuda National Trust thanks AXIS Capital Holding Limited for sponsoring this publication and Lindsey Lehman and Anna Ridgeway for contributing their skills and time as volunteers to this publication.



To protect Bermuda's unique natural & cultural heritage forever

Learning with the Bermuda National Trust AXIS Education Programme

The Bermuda National Trust's teacher resources focus on nature reserves and historic homes owned and maintained by the Trust, offering comprehensive resources and creative learning experiences for visitors, teachers and students. We provide first-hand experiences that cannot be re-created in the classroom. Guided tours can be scheduled with a member of our education staff for primary, middle and senior level classes. It is our hope that students will visit all Trust properties, beginning at primary 1 - 2, and experience repeated visits throughout later primary, middle and senior years. Repeat visits help students build on their prior learning and develop a deeper understanding of the concepts and terms associated with each site. Senior students are encouraged to visit each site to learn about the care and preservation of nature reserves and historical homes. Opportunities are available for senior students to participate in our AIM Programme, allowing them to volunteer their time caring for Trust properties, which can be applied to required community service hours.

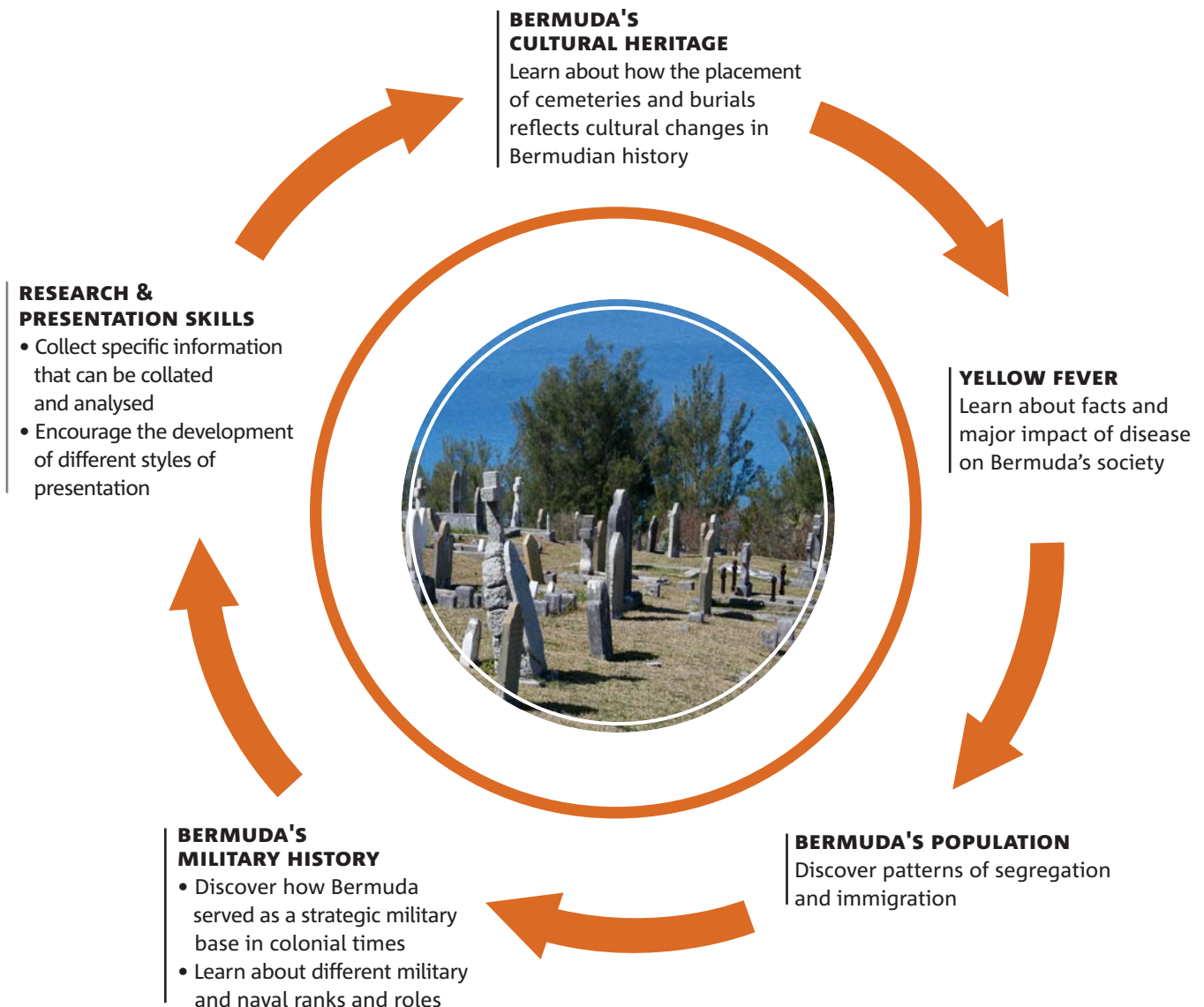

Table of Contents

5	Why Should Students learn about Historic Cemeteries?
6	Note to Teachers
7	Scheduling a field trip to St. George's Military Cemetery, St. Peter's Church - Burial Ground for Slaves and Free Blacks or the Royal Naval Cemetery
8	Ensuring a Safe and Enjoyable Visit
9	Island Map - Bermuda National Trust Properties
9	Directions - How to get to the St. George's Military Cemetery, St. Peter's Church - Burial Ground for Slaves and Free Blacks and the Royal Naval Cemetery
10	Introduction to Bermuda's Historic Cemeteries:
13	• Eastern Cemeteries
18	• Central Cemeteries
20	• Western Cemeteries
23	• Outlying Island Cemeteries
26	Teacher Resources/Activities
26	Before your Visit • Introducing Students to Bermuda's Historic Cemeteries
27	• Activity 1 – The Growth and Development of Bermuda. What is Yellow Fever?
28	• Activity 2 – The Military in Bermuda in the 19th Century
29	• Activity 3 – The Military in Bermuda in the 20th Century
30	During your Visit • Class Field Trip Activities
31	St. George's Military Cemetery, Grenadier Lane, St. George's
31	• Activity 1 – Highlighting Soldiers in the British Armed Forces
32	• Activity 2 – Military Ranks
33	• Activity 3 – The Children Buried at St. George's Military Cemetery
34	St. Peter's Church - Burial Ground for Slaves and Free Blacks
34	• Activity 1 – Highlighting Pilot James Darrell
34	• Activity 2 – Research Headstones and Inscriptions
35	Royal Naval Cemetery, Ireland Island
35	• Activity 1 – Highlighting Soldiers in the British Forces
36	• Activity 2 – Military and Naval Ranks
37	• Activity 3 – Royal Navy Soldiers and Ships
38	After your Visit • Additional Information & Activities
39	• Activity 1 – Comparison of Cemeteries
39	• Activity 2 – Visit to the Bermuda National Library
39	• Activity 3 – Class Presentations
40	Extension Activity • Royal Naval Cemetery
41	Map of St. George's Military Cemetery, Grenadier Lane, St. George's
42	Map of St. Peter's Churchyard
44	Map of Royal Naval Cemetery, Ireland Island
46	Glossary & Appendix
47	Curriculum Links
49	References
50	Field Trip booking form
51	Waiver form

Why Should Students learn about Historic Cemeteries?

Historic cemeteries offer a number of insights into life in the past in Bermuda. They provide students with a primary source of historic research. When we study the information on headstones we can often discover much about the lives of the individuals buried there and about the history of Bermuda.



Arranging a Class Trip/Teacher Resources

>Note to Teachers

There are many historic cemeteries in Bermuda that are worth a visit. In this guide we are focusing in particular on three easily accessible cemeteries: the St. George’s Military Cemetery, St. Peter’s Church - Burial Ground for Slaves and Free Blacks in St. George’s and the Royal Naval Cemetery on Ireland Island. Our goal is to make your students’ field trip valuable and meaningful and to stimulate a life-long interest in history. This resource was created to provide background information on the cemeteries along with suggested activities that you can conduct with your students before your class visit to the cemetery and afterwards, to enhance your students’ learning experience, and help you achieve your curriculum goals.

There are a few options to support you before and after the field trip:

Teacher workshop

We can provide a ‘group teacher workshop’ in our AXIS Education Classroom prior to a field trip with your students. A minimum of 10 teachers is required, maximum group size is 15. The time allotted for the workshop is 1.5 to 2 hours.

The overall focus of the workshop is to:

- Obtain a copy of the Introduction to Cemeteries in Bermuda resource booklet
- Review the history of each site, resources and suggested activities
- Obtain materials to create a map of Bermuda and labels to show the location of Bermuda National Trust properties and other local landmarks, which can be used in their classroom introductory lesson before taking the class tour
- Network with other teachers to brainstorm ideas for additional activities that can be offered to promote student learning before and after the class tour

Three-Part Learning Experience

We offer a three-part learning experience. After booking a field trip, a Bermuda National Trust educator can provide an introductory lesson for your students in your classroom, providing information about the site. This is an excellent preparation for the field trip which builds on students’ prior knowledge and is helpful for engaged learning during the field trip. After the site visit a follow-up lesson can also be scheduled. Students will be guided in a review of their field trip and summarise their new knowledge.

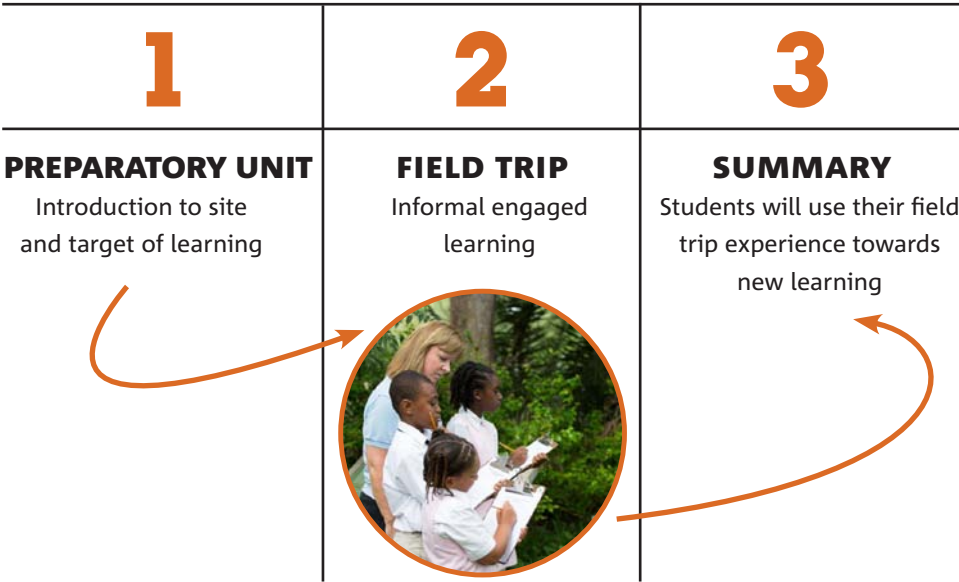

Follow up Visit

Teachers are welcome to schedule a follow up visit for their class at our AXIS Education Classroom at our Waterville site after the tour, preferably within two to three weeks. The goal is to review what students learned about the cemetery and for them to share/ highlight the work they have completed. The time allotted for this student follow up visit at Waterville is approximately 1.5 hours.

Tips for Using This Resource

Reading through the background information will assist teachers in answering the more probing questions from inquisitive students, and help create additional activities that extend the learning associated with Bermuda's cemeteries.

The Introduction to Cemeteries in Bermuda resource booklet and map of Bermuda are also available to download from our website www.bnt.bm.

After booking the tour, teachers are encouraged to review the information that follows:

- The history of cemeteries and map showing the location of the cemeteries
- The definitions of key terms relating to cemeteries, graves, military and naval activities in Bermuda

In preparation for the tour, initial classroom activities are provided and meant to assist students in recalling their prior knowledge of historic cemeteries, and to learn specific vocabulary about them. The scope of students' learning will depend on the grade level, their prior exposure to cemeteries, background knowledge and understanding of terms. Although the activities provided begin at the lower primary level, teachers of older students can modify the activities for the grade and developmental level of their students' abilities. We hope that teachers will generate new ideas for creating additional activities and share them with our education staff.

We recommend the following activities:

The activities provided focus on the Cambridge International Curriculum Key Stages 1 and 2, Primary Stages 5 and 6, Secondary 1 and Middle Stage 8. Curriculum links to activities are provided for integrating the Bermuda Ministry of Education's Science and Social Studies. While looking through the activities provided, teachers may also think of ways to integrate all other subjects. The teacher's method of preparation and delivery will vary with students' needs and interests.

PRE FIELD TRIP ACTIVITIES

Activities listed in this section will introduce students to the historic background of the cemeteries. Students will learn about the role of the military in Bermuda during the 19th and 20th centuries and the effect yellow fever had on the island community.

FIELD TRIP ACTIVITIES

The listed field trip activities will help teachers and students to develop observation skills while searching for answers to the pre-set questions. They will assist students to stay focused on the significant facts at each cemetery.

POST FIELD TRIP ACTIVITIES

Activities listed in this section encourage students to make comparisons between the different sites and to research further with the aim of gathering material for later use in oral presentations.

*Scheduling a field trip to St. George's Military Cemetery, St. Peter's Church - Burial Ground for Slaves and Free Blacks or the Royal Naval Cemetery

To schedule a trip to these cemeteries download and complete a school field trip booking form on our website, www.bnt.bm (found under the school tours heading) or copy the form in the back of this book. Return the form via email to: education@bnt.bm.

The ratio of guided tours is one adult for every ten children. Additional adults are welcome.

We continue to seek ways to improve our educational programmes and welcome suggestions for enhancing this resource and the experience for the children. Please contact us with any suggestions or comments.

The Education Team
Bermuda National Trust
education@bnt.bm • 236-6483

Ensuring a Safe and Enjoyable Visit

Before teachers come with their students they should be aware that the paths through the cemeteries are not suitable for wheelchairs. Individuals with physical limitations will need assistance. To ensure that students and adults have an enjoyable experience, it is essential for teachers to:

- Assume responsibility for the safety, behaviour, support and welfare of students
- Ensure that students are prepared with appropriate clothing and walking shoes
- Prepare and carry a register to include the names of all students with emergency and medical information
- Ensure that each student has a completed the Bermuda National Trust parent/guardian consent to attend the tour, which includes our photo release policy. This form is included in the appendix. Teachers need to notify the Trust staff member leading the tour of any students who do not have prior consent to be photographed
- Provide necessary information for the Trust staff member about relevant student learning needs, behavioural support, allergies or health concerns
- Bring a first aid kit and a cell phone to be used in the event of an emergency
- Teachers and other adults are to refrain from using cell phones and texting for personal use during the tour
- We ask that teachers support students in their learning before, during the tour and after their visit

A historic cemetery is an outdoor history museum, wildlife refuge, botanical garden and art gallery all rolled into one. They are people's final resting places and should be treated as sacred and hallowed ground. Please use the following bulleted points to address the issue of etiquette with your students before their visit.

- Unless otherwise directed, stay in the designated walking areas. Do not walk across cemetery plots or play in between headstones
- Show respect and do not intrude on funeral or memorial services
- Do not add to, take away from, or modify a memorial in any way
- Running, playing, or making loud noises are not appropriate in cemeteries
- Do not litter or interfere with plants or the wildlife that inhabit the site
- Always be respectful and aware of your surroundings.

Bermuda National Trust

Nature Reserves, Historic Homes & Cemeteries

- NATURE RESERVES
- HISTORIC HOMES
- HISTORIC CEMETERIES

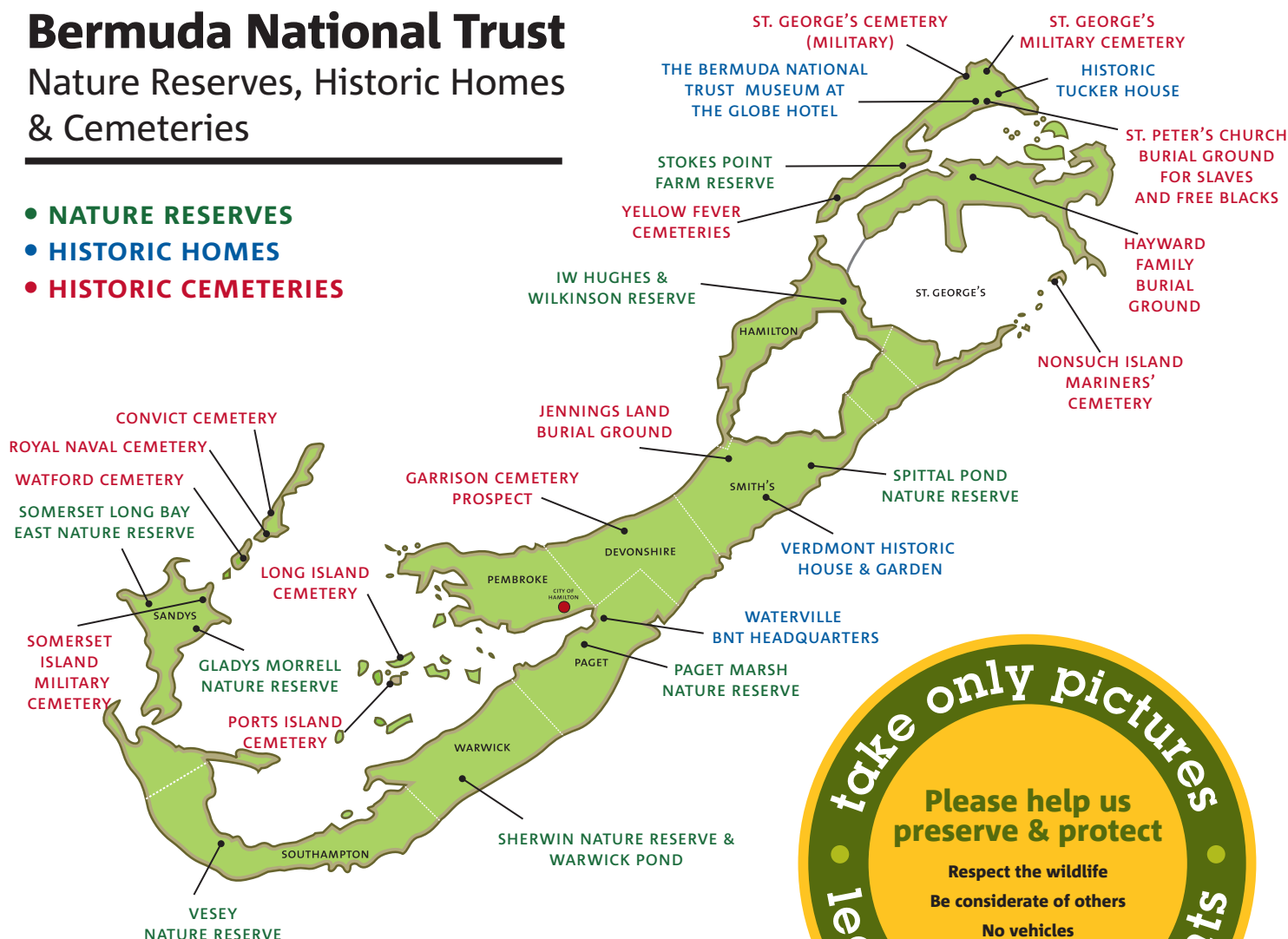

Directions

St. George's Military Cemetery:

This cemetery is located at the eastern end of St. George's Island at the junction of Grenadier Lane and Barry Road overlooking Warden Hole and the Narrows. It is enclosed by a Bermuda limestone wall with two entrances: one via steps is at the bottom end of Grenadier Lane and the other, via a ramp, is from Barry Road. The Bermuda National Trust marker is at the ramp entrance.

St. Peter's Church - Burial Ground for Slaves and Free Blacks

This cemetery is located in the western section of the cemetery at St. Peter's Church, York Street, St. George's.

Royal Naval Cemetery, Ireland Island South

This cemetery is located between Malabar Road and Craddock Road, by Parson's Bay across the widest point of Ireland Island. Take Malabar Road, the main road to Dockyard, which passes the north-west end and from where the cemetery is visible.

AN INTRODUCTION TO BERMUDA'S **Historic Cemeteries**

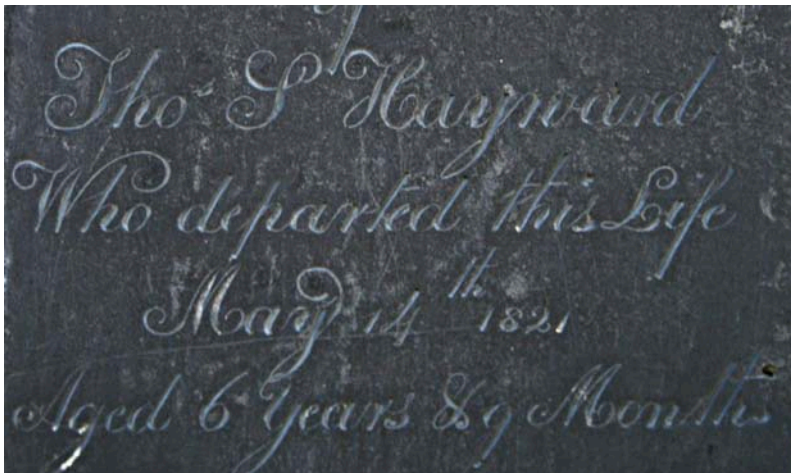

BERMUDA IS FORTUNATE TO HAVE SO MANY WELL-TENDED HISTORIC cemeteries, thanks to the Bermuda National Trust and the individuals who look after them with such dedication. Here lie the remains of admirals and shopkeepers, sailors from across the world, soldiers of the British Empire, prisoners of war, diplomats, governesses, masons and mothers, ‘black, white and other’; all are represented in these graveyards. In the military cemeteries are the graves of those who were sent to Bermuda from all over the world, who contributed something, however small, to making the country what it is today, and who died before they could return to their homeland. A few were famous, most had stories to tell, and some barely lived at all.

These burial grounds merit recognition and protection as green spaces as well as historic monuments freely accessible to all. They are vulnerable to damage, both natural and human. Already the only record remaining of the people interred in one military cemetery, apart from the remaining few Commonwealth War Graves, is the Royal Engineer’s plans ‘buried’ in the Archives. People who had relatives laid to rest there can no longer visit their graves. It is our moral responsibility to preserve the memorials which remain.

Far from finding them sad, gloomy places, many people enjoy the cemeteries. Some come as regular walkers who have grown to love the peaceful spaces amid the busy environment of Bermuda, others just come across them accidentally and become engrossed in reading the memorials - young men lying so far from home, families devastated by disease or disasters at sea.



Planned maintenance is vitally important and the Trust's belief in regular upkeep - supported by the Bermuda Government, the Commonwealth War Graves Commission and the West End Development Corporation - makes these beautiful graveyards accessible to all who care to venture into them. The dignity of the Victorian memorials, the life-size military accoutrements, such as the carvings of ships, crosses and lambs, are kept in good repair through the dedication of individual craftsmen, despite hurricanes and vandalism. Memories of days gone by are kept alive in the inscriptions: sailors who fell from aloft, mothers who died in childbirth, and prisoners who grew sick on the prison hulks. The cemeteries are also host to Bermuda's wildlife, offering a refuge in a built-up environment. These are places of reflection, spaces for life, and sanctuaries for the 21st century.

The Historical Monuments Trust and its successor the Bermuda National Trust have long cared for cemeteries as both historic sites and open spaces. In 2002, Hilary and Richard Tulloch began an exhaustive effort to record the headstones and memorials of all the graves and history of the cemeteries in the Trust's care. Their report *Died at Bermuda* as well as their 2011 publication *Bermuda Memorial Inscriptions* are the basis for much of this information. Most of the military cemeteries are leased to the Trust by the Bermuda Government. For many years the maintenance work was supervised by honorary wardens. Michael Woods was the first and when he retired he was ably succeeded by Andrew Bermingham. As of 2013, the National Trust cares for thirteen historic cemeteries. There are three that it owns: Hayward Family Burial Ground, Jennings Land Burial Ground and Long Island Cemetery.

Eastern Cemeteries

ST GEORGE'S MILITARY CEMETERY/GRENADIER LANE, ST GEORGE'S

THIS 1.66 ACRE WALLED CEMETERY ON THE EASTERN SHORE OF ST GEORGE'S WAS PRIMARILY a cemetery for yellow fever victims. It was part of the St George's Garrison, the earliest establishment of the British Army in Bermuda. There are 256 memorial sites and the names of 539 individuals appear on the memorials. The majority of the deaths they record occurred during the yellow fever epidemics of 1830-1870. The three main monuments are for the yellow fever victims of the Royal Artillery, the Royal Sappers & Miners and the Queen's Regiment. It is presumed that this cemetery was closed about 1870 when the new military cemetery on Cemetery Hill (St George's Military), Secretary Road was opened.

Grenadier Lane, on which the cemetery is located, is named for the 2nd Battalion of the Grenadier Guards. The Battalion was banished to Bermuda in 1890 and 1891 for insubordination. London was "too hot to hold them" according to the New York Times, which also reported that the troops were so unhappy about the heat in Bermuda that further instances of insubordination occurred. Whatever the circumstances of their exile, the presence of the Grenadiers provided the chance for a year of extravagant entertainment, receptions and balls. HRH Prince George, who later became King George V, visited Bermuda during this time, a cause for even more celebration on the island.



ST. PETER'S CHURCH • BURIAL GROUND FOR SLAVES & FREE BLACKS

/YORK STREET, TOWN OF ST. GEORGE'S

ST. PETER'S CHURCH IS THE OLDEST ANGLICAN CHURCH IN CONTINUOUS USE IN THE NEW WORLD and part of a UNESCO world heritage site. In 2005 Hilary and Richard Tulloch completed a survey of the inscriptions within the churchyard. Three years later archaeologists from Boston University and local volunteers undertook six weeks of excavations at various sites within the core of St. George's and completed a survey of all the memorials in the churchyard. The team created a map of all the stones in the yard, including not only the ones with inscriptions but also those with no visible inscription and transferred the data into a 3-D model. This model is integrated into the St. Peter's Church website for visitors to view.

Walking through the churchyard one notices that the graves surrounding the church are the ones of white Bermudian families and separated by a wall in the western section of the churchyard are the headstones of buried slaves and free black people.

Hilary and Richard Tulloch (Tulloch 2011) identified 183 different graves in the western section with many barely noticeable. Based on the inscriptions legible today black people were buried here from 1745 to 1853, but others might have been before or after these dates without leaving a record for us to identify today.

Most graves have well weathered headstones and only a few contain slate tablet inserts with inscriptions. One tablet is well preserved and is erected in memory of Robert Simmons:

*Memorial / of / Robert Simmons / who was unfortunately / drown'd, the 12th
of may / 1830. / Aged 56 Years / He was well esteem'd by all who knew him,/
and left a wife / and 2 children to lament / his loss.*

The most famous grave is located near the entrance. It is the grave of pilot James Darrell who lived from 1749-1815. He was one of the most respected and competent black pilots in Bermuda. In May 1795, James Darrell so skillfully piloted the 74-gun HMS *Resolution* into Murray's Anchorage on the north shore near Tobacco Bay, St. George's that Admiral George Murray petitioned the Governor for Darrell to be granted his freedom. This was granted by Governor James Crauford who released him from his enslavement on March 1, 1796. Admiral Murray later established the King's Pilots and Darrell was one of the first to be appointed.

Today the graveyard is identified by a plaque on the wall saying "Burial ground for slaves and free blacks" and a bronze plaque created by Bermudian sculptor Carlos Dowling indicating the official African Diaspora Heritage Status of St. Peter's Church.



African Diaspora Heritage Trail • Bermuda

The Bermuda Department of Tourism and the international body **African Diaspora** created a trail linking sites, monuments and museums which have a common legacy of slavery. These sites were officially designated as part of the transnational heritage tourism initiative formed in 2001 and are part of the **UNESCO Slave Route Project** with the aim to protect and educate about the heritage and culture of those belonging to the African Diaspora.

HAYWARD FAMILY BURIAL GROUND/EMILY'S BAY LANE, ST. DAVID'S

THIS SMALL FAMILY GRAVEYARD LIES AT THE BACK OF BAY HOUSE. THE GIFT OF HOWARD Smith, the graveyard is surrounded by an old wall and contains a few raised tombs and some attractive inscribed plaques in memory of members of the Hayward family.

Two of the graves are thought to be those of Martha Hayward and her husband Lieutenant William Lang. Lang served with the 46th Regiment of Foot under Lord Cornwallis in the American Revolution. Bermuda legend has it that when he was stationed in Bermuda he had business with Anthony Hayward and when he went to visit him, he was struck by the beauty of Hayward's daughter Martha. It was love at first sight and without her father's knowledge they married in St. George's at St. Peter's Church, returning later to her home to seek forgiveness. Lang is credited with bringing the first peach seeds from Madeira and there is a large peach tree growing over the western side of the graveyard to this day.

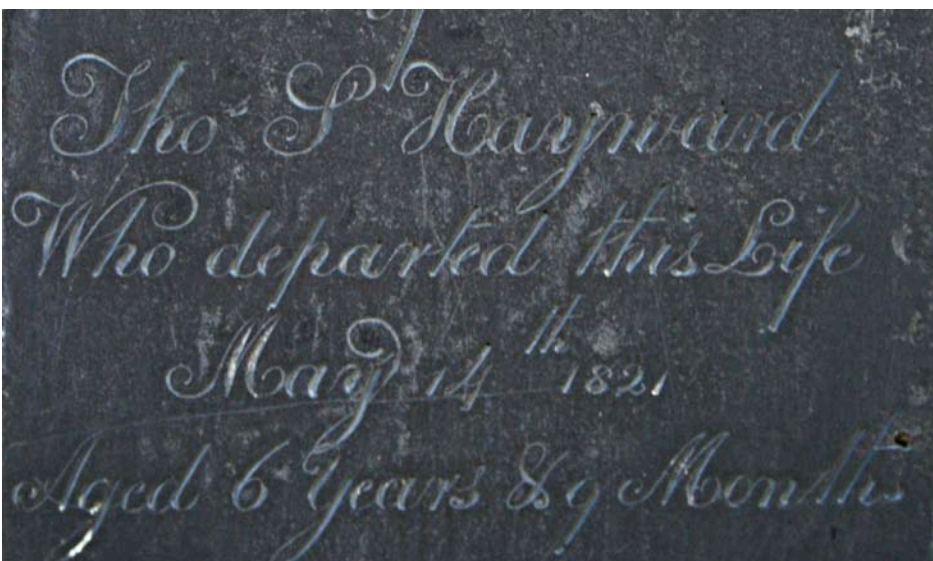

ST. GEORGE'S CEMETERY MILITARY /SECRETARY ROAD, ST. GEORGE'S



THIS BEAUTIFUL GRAVEYARD OVERLOOKS MURRAY'S anchorage on the North Shore and is divided into two sections side by side of which the eastern one is mostly civil and the western military. Bermuda stone walls were erected to separate the two cemeteries, but some military graves ended up on the wrong side of the wall, and there are also civilian graves just inside the entrance to the military section.

The larger southern, or higher in the civil section, area was for the Church of England and the northern lower section, below the main pathway, was designated for Roman Catholics. Markers denoting this division are visible on the main pathway and on the wall opposite the main gateway. The entire hillside is a peaceful place away from the bustle and buzz of daily life. The land for the western cemetery, an area of 1.09 acres, was purchased in 1868 from Mr. and Mrs. J.D. Musson. The new burial ground, which bordered the old civil section known as St. George's Cemetery, was named

St. George's Cemetery (Military). The absence of mention of yellow fever as a cause of death in the military cemetery is unique in St. George's graveyards, although two of the remaining memorials mention 'fever' and 'enteric fever', now known as typhoid.

One of the most significant graves is that of Scotsman George MacKenzie Samson, VC. Petty Officer Samson was the first Royal Naval Reserve to be awarded the Victoria Cross, Britain's highest award for gallantry, at Gallipoli, Turkey, in 1915. Born in Carnoustie, Angus, in 1889, Samson was passing Bermuda while serving on a merchant ship when he developed pneumonia and died upon landing. Samson was given a full military funeral procession through St George's and was buried on 23 February 1923.

The cemetery forms part of the land which was at one point allocated to the Colonial Secretary, holder of the administrative role that linked colonial Bermuda and London. The post came with 50 acres of farmland and Secretary Road cuts through the middle of it.



FERRY POINT MILITARY CEMETERY & FERRY REACH CEMETERY

/FERRY ROAD, ST. GEORGE'S

AFTER THE YELLOW FEVER EPIDEMIC OF 1853, THE BRITISH GARRISON KEPT ABOUT HALF ITS soldiers encamped at Ferry Point. Many of the soldiers died of yellow fever and were buried in two cemeteries located at Ferry Road in St. George's. The smaller one, Ferry Point Military Cemetery, now stands simply as a small walled area, with no visible memorials. There is evidence that there were several headstones in the 1950s but the Tullochs believe they were relocated to the Grenadier Lane cemetery. In 1782 barracks had been built near the site of the Ferry Point Cemetery and the walled area was where livestock had been kept. It had varied uses over the years: it was the site of a cockfight in 1785, a cemetery by the early 19th century and later it became a garden.

Ferry Reach Military Cemetery was established later and may have been a result of both the Ferry Point Cemetery being full due to the high death rate of the 56th Regiment, and a growing awareness that it was better to locate yellow fever cemeteries further away from places of habitation. It has a large cross and two other memorials to commemorate soldiers from the 2nd Battalion 2nd Queen's Royal Regiment who died during the yellow fever epidemic of 1864.

This area of Bermuda was once the main route for people and goods travelling from St. George's to the mainland. A ferry crossing was established in the 1600s, which connected St. George's to Coney Island. Since the building of the causeway in 1871, this area has become somewhat deserted.

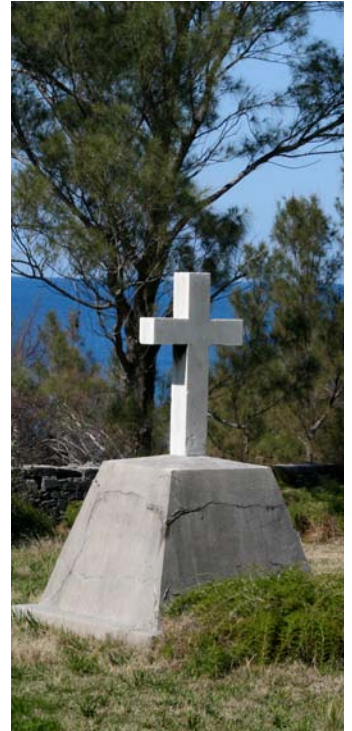

PROSPECT HILL GARRISON CEMETERY/GREENWICH LANE, DEVONSHIRE

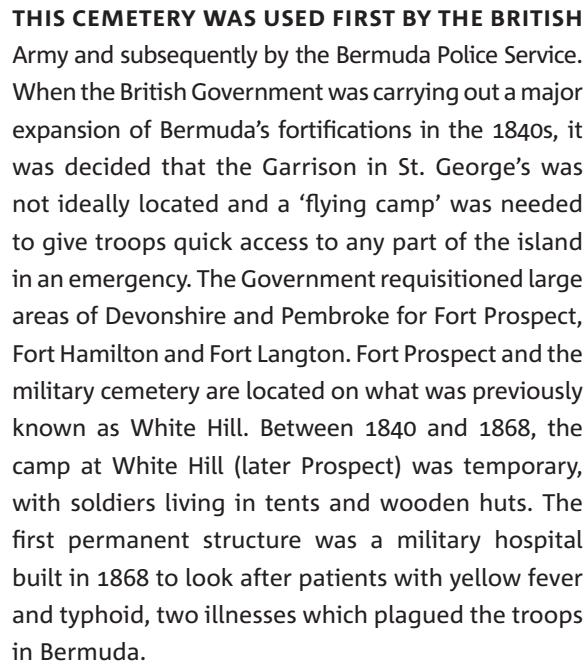

A photograph of a cemetery. In the foreground, there is a large, light-colored, arched gravestone on the right and a smaller, dark, rectangular gravestone on the left. The background shows more trees and other graves.

JENNINGS LAND BURIAL GROUND/JENNINGS ROAD, SMITH’S

A SMALL ANCIENT BURIAL GROUND OVERLOOKING THE NORTH SHORE NEAR FLATTS, Jennings Land Burial Ground was given to the Historical Monuments Trust in 1953 by three daughters of farmer Thaddeus Trott who owned 78 acres of land in the area. The deeds refer to the burial ground as belonging to the family ‘Jennyns’. The Jennings family was prominent in Bermuda in the 17th century and the Norwood survey of 1663 shows the land on which the tombs stand as belonging to Richard Jennings. The burial ground today has two unmarked stone graves and it is not known which members of the family were buried in them.

In 1955, the Monuments Trust carried out a restoration of the site. They cleared the land, restored the graves and erected a rustic fence. We have no way of knowing how faithful the grave restoration was to the original monuments. Today both graves have rather primitive headstones, one almost cruciform and the other semi-circular. It is believed there had been more grave markers and tombs during an earlier period; one eye-witness described an open vault visible in 1939. This area stands as a relic of the days when burial grounds were on family land.



Western Cemeteries

CONVICT CEMETERY/COCHRANE ROAD, IRELAND ISLAND SOUTH

THIS SMALL CEMETERY IS HIDDEN BEHIND A ROW OF FORMER DOCKYARD EMPLOYEE houses. A tranquil spot on the northern shore, it has nine visible graves of which only five have inscriptions. The graves all date from 1843 to 1846 and two of the men whose names are still visible are known to have been convicts at the time of their death. The first convicts were brought to Bermuda from England in 1824 on HMS *Antelope* and the cemetery dates from about this time, but there is no evidence that it was ever consecrated. We know that by 1898 the cemetery was no longer used because cartographer Lieutenant AJ Savage marked it 'disused' on his survey map of that year.



SOMERSET ISLAND MILITARY CEMETERY/MANGROVE BAY ROAD, SOMERSET

SOMERSET ISLAND MILITARY CEMETERY LIES IN SANDYS PARISH ON THE NORTH SIDE of Somerset Island, on the right of the main road when traveling from Somerset Village to Dockyard, just before reaching Watford Bridge. The so-called 'new military cemetery at Somerset' was consecrated in 1905. There are only 21 visible graves but records indicate that many more people are buried at this site. The cemetery is a tranquil 2.24 acre spot looking out to Mangrove Bay.

The earliest remaining memorial is dated 1904 and the most recent 1918. Of the 21 visible graves, 13 of the headstones are Commonwealth War Graves Commission headstones commemorating soldiers who died in service during the First World War, 1914-1918. The Bermuda National Trust erected a small wall around the cemetery in 1986 which helps to mark the area.

Nearby there is a monument to the memory of soldiers from the 4th Battalion British West Indies Regiment, who died in Bermuda of pneumonia in 1916; it used to be next to a small chapel which has since been demolished.



ROYAL NAVAL CEMETERY/IRELAND ISLAND, SANDYS

THIS LARGE NAVAL CEMETERY, 2.73 ACRES AT THE SIDE OF THE ROAD LEADING INTO Dockyard, was known as the Glade. Ireland Island was bought by the Admiralty in 1809 and the cemetery consecrated in 1812. The first burial ground was a narrow strip which is now the central portion of the cemetery; it was enlarged several times, notably after three yellow fever epidemics in 1837, 1843 and 1853. As the cemetery filled up, the categories of people who could be buried there were reduced, starting with the exclusion of convicts in 1849. By 1853 only Royal Naval personnel and residents of Ireland Island could be interred there. January 3rd, 1854 was marked as a day of thanksgiving in Bermuda for those who survived the dreadful scourge. However, it was not the last yellow fever epidemic and it took another thirty years to completely eradicate the mosquito-borne disease in Bermuda.

The cemetery lies in a depression, with the earliest graves at the lower centre, and the later graves on the rising ground around them. Five admirals are buried here, as well as children and sailors. The oldest gravestone now legible is that of Sergeant John Kitchener, late Royal Marines, who died in 1816, with its cautionary verse urging the onlooker to prepare to meet his God. Several of the older headstones have poetic inscriptions, some personal and others supplied by stonemasons as far afield as Nova Scotia and England. In contrast are the Commonwealth War Graves Commission headstones which stand out in their stark simplicity. The cemetery contains the graves of servicemen from the Second World War, when Bermuda was a transit point in the Battle of the Atlantic, and memorials to some of those who were buried at sea. Overlooking the whole cemetery is the Oration Stand, a reproduction of the original structure from which the funeral oration, or formal speech at a funeral, was given.



WATFORD ISLAND MILITARY CEMETERY

/MALABAR ROAD, WATFORD ISLAND, SANDYS



THIS IS A SMALL CEMETERY CREATED ON WATFORD Island in 1887 as a graveyard for soldiers and their families. Earlier in the century the whole island had been used as a burial ground for the dead of the army of convict labour that built Dockyard between 1824 and 1863. They lived in rotting hulks of ships moored just offshore, in crowded and filthy conditions; the mortality rate from dysentery and yellow fever was high. Convicts were buried in the Glade, Ireland Island until 1849 when it seemed to be filling up. Then Watford Island was used to bury dead convicts and convict officers. In 1855 it was reported that the island had received 458 bodies and was almost full. For the remaining years of convict labour those who died were buried on Long Island. Perhaps because their graves were usually marked with wooden crosses, tablets commemorating individual convicts are rare.

In 1925 the remaining few memorials were taken from other parts of the island and placed together along the north-eastern wall of the military cemetery. On November 5th, 2004 the remains of five men, found exposed after Hurricane Fabian, were reburied in a single grave within the walled cemetery. The military memorials date from 1888 to 1899, with the addition in 1980 of the Queen's Regiment monument of 1866, relocated from Boaz Island. The burials included several children and four young Grenadier guardsmen who died in 1890 or 1891 during the 2nd Battalion's year-long stay.



Outlying Island Cemeteries

LONG ISLAND CEMETERY/LONG ISLAND, GREAT SOUND



LONG ISLAND CEMETERY, IN GREAT SOUND, IS ONE of the few historic cemeteries owned outright by the Trust having been donated by Government in 1980. It is, in fact, three cemeteries. The earliest is a small enclosure on the west side with two graves of men from HMS *Forth* which date from 1817.

In 1854, the Royal Naval Cemetery at Ireland Island was reaching capacity, and Long Island became the main burial ground for yellow fever victims. In 1855 it was decided that it would also be used to inter convicts. The earliest extant headstone referring to yellow fever is dated 1856, and there are many graves commemorating yellow fever victims in 1864, including marines and workers from Boaz Island. Two doctors, 'poor Gallagher and Richards' who died trying to help the victims, are also thought to be buried here, although there is a memorial at the Royal Naval Cemetery to these two men.

The cemetery was later used for Boer prisoners of war who died while they were held captive in Bermuda on other islands in the Great Sound in the very early part of the 20th century. The hospital which served these internees was on Ports Island. Their graves are marked

only by a number corresponding with the main obelisk in the centre of the graveyard. There are 40 names on the obelisk which was erected by the survivors while they were awaiting repatriation. In 1903 the 56th Regiment built a stone wall to enclose the graveyard, and it was dedicated at that time by the Bishop of Newfoundland and Bermuda.

Over the years the care of these island cemeteries has been, logistically and with much hard physical work, supported by Long Island neighbours David Lines and, more recently, Jim Butterfield.



NONSUCH ISLAND MARINERS' CEMETERY/NONSUCH ISLAND

NONSUCH ISLAND IS ONLY ACCESSIBLE BY BOAT, WITH PERMISSION FROM THE Government Department of Conservation Services, as the island is a protected nature reserve. This small cemetery in the centre of the island has been used over the years by the island's inhabitants. Between 1865 and 1910 Nonsuch served as a yellow fever quarantine station and hospital, and the cemetery was established in that time. The island was a marine research station for a few years, and later a home for delinquent boys. In 1963, Dr David Wingate took up residence as the island's warden, and began the process of re-establishing Bermuda's native flora and fauna, making Nonsuch the living museum it is today. Those interred on Nonsuch have included members of the military, sailors, scientists and, sadly, Anita Wingate, Dr Wingate's first wife and the second staff person hired by the Bermuda National Trust. Many of the graves are no longer visible. In 2000 cedar fencing was put up to enclose the greatest concentration of the graves, many of which would have been marked with simple wooden crosses that have disintegrated over time.



PORTS ISLAND CEMETERY/PORTS ISLAND, HAMILTON HARBOUR



THIS SMALL CEMETERY LIES ON THE NORTHEASTERN part of this large island in the Great Sound. The island itself was bought by the Admiralty Board in 1809 at the same time as the purchase of Ireland Island. The island was used to house the sick from 1816 until 1818 when the Royal Naval Hospital was built at the Dockyard. In 1834 the island was designated a Naval Quarantine Station where ships arriving in Bermuda were directed if there was sickness among the crew, as in the case of the *Pearl* which arrived with yellow fever on board in 1837. Convalescing convicts were sent there in 1843, and in 1852 *L'Armide*, a French hospital ship, came up from the West Indies with yellow fever. Of the 46 people who landed on the island, 11 died and are buried here. In 1853 another outbreak of the disease hit soldiers of the Royal Artillery and the 56th Regiment. Those who died are buried at Ports Island, along with the sergeant who had nursed them and several of his family. Further yellow fever deaths occurred in 1856, 1863, 1864 and 1869. In 1873 the *Doris* brought 40 cases of typhoid from Barbados.

From 1901 until 1903 the island was the location of a prison hospital 'under canvas' for the Boer War prisoners, although those who died were buried in the Boer Cemetery on Long Island. The island was also used to incarcerate German prisoners of war during the First World War.

Five graves or monuments are still visible. One commemorates the dead of the Artillery and 56th Regiment, one of the crew of the *Armide* and one is the grave of an eight year old boy. There is one further headstone with no visible inscription. In 2004 Hilary and Richard Tulloch uncovered the grave of Gunner James Gregg, a victim of yellow fever from HMS *Terror* in 1864. Because of the overgrown state of the land around the cemetery area, they think it likely that further memorials may yet be discovered.



Teacher Resources/Activities

Before your visit/

Introducing Students to Historic Cemeteries in Bermuda

These activities are designed to be completed in advance of the field trips.

OBJECTIVES

- To introduce historic cemeteries
- To develop observation skills

*ACTIVITY 1 The Growth and Development of Bermuda/ What is Yellow Fever?

The teacher will introduce yellow fever and review data about yellow fever deaths in Bermuda with the students. They will answer the provided questions.

*ACTIVITY 2 The Military in Bermuda in the 19th Century

This activity introduces the students to the role of the military in Bermuda in the 19th century.

*ACTIVITY 3 The Military in Bermuda in the 20th Century

Changes in the military power and Bermuda's importance during World War I and II are explained. Three questions are listed to challenge the student's comprehension.

*ACTIVITY 1/CEMETERIES

The Growth and Development of Bermuda/ What is Yellow Fever?

Yellow fever is a very serious viral infection that is spread by the bite of a female mosquito. It mainly occurs in hot tropical countries. It is thought to have spread from Africa and came to Bermuda through the slave trade. Two outbreaks of yellow fever occurred in Bermuda in the 18th century and nine in the 19th century. Symptoms included reddening of the eyes, fever, chills, sickness, and muscle pain. There was no vaccine in the 19th century and so in many cases the illness was lethal. The virus would attack the liver and cause jaundice (yellowing of the skin). At this time it was thought that the disease was spread by unsanitary conditions.

The table below shows the number of deaths in Bermuda from yellow fever during four major outbreaks.

Source: Bermuda History-Epidemics, Yellow Fever & Biowarfare in the 1800s - pdf

YEAR	TOTAL POPULATION IN BERMUDA	DEATHS DURING THE YELLOW FEVER EPIDEMICS					
		CIVIL POPULATION		MILITARY	CONVICTS & OFFICERS	TOTAL DEATHS	DEATH RATE
		WHITE	BLACK				
1843	9,930	82	102	93	119	496	4.9 %
1853	11,092	130	160	361	163	814	7.3 %
1856	11,092	80	160	4	37	281	2.5 %
1864	13,536	217	20	206	28	471	3.5 %

QUESTIONS FOR DISCUSSION

1. Which year saw the most deaths from yellow fever? Which year saw the least deaths?
2. What was the total number of civilian deaths from yellow fever between 1843 and 1864?
3. What was the total number of military deaths from yellow fever between 1843 and 1864?
4. How accurate do you think these records are? Why might some deaths not have been recorded?
5. What actions may people have taken to stop the spread of the disease in the mid 19th century?
Would any of these actions have helped?
6. What problems did this epidemic cause in Bermuda?

*ACTIVITY 2/CEMETERIES

The Military in Bermuda in the 19th Century

The Bermuda Garrison was the military establishment on Bermuda that was run by the British Army. It served in Bermuda from 1701 until 1957. The main role of the garrison after 1809 was to protect and defend the Royal Naval Dockyard and other facilities that were important to Britain.

During the 19th century, the Royal Engineers, who were an important part of the Garrison, improved many coastal fortifications, such as Fort St. Catherine, and built many new ones. They constructed Gibb’s Hill lighthouse in 1844 and linked St. George’s Island to the main island with a new causeway. They surveyed the island, built new roads and improved existing ones.

Originally most of the soldiers were based in the St. George’s Garrison, which had a large barracks and a hospital to the east and north of the town. However, many soldiers moved westward when Hamilton became the capital city in 1815 and the Royal Naval Dockyard became larger.

The following corps (groups) of the British Army served in Bermuda in the 1800s.

CORPS	ROLE
Royal (Garrison) Artillery	To man the heavy guns of Bermuda’s forts and fortresses.
Royal Highlanders	Part of the infantry. These men were trained to fight on foot and defeat the enemy in face-to-face combat.
Royal Engineers	To build and repair. They are made up of a huge range of trades, such as bricklayers, carpenters, surveyors, drivers, construction workers and architects.
Royal Sappers and Miners	Specialists in construction and technical support. They supported the Royal Engineers. They were responsible for dangerous work such as digging tunnels, mining and any underwater work.
Bermuda Volunteers Rifle Corps	An all-white, racially segregated group of men who would volunteer in time of need, established in 1894.

QUESTIONS FOR DISCUSSION

1. Which army corps do you think had the most serving men in Bermuda? Why?
2. What sorts of changes do you think the British army brought to Bermuda in the 19th century?
3. If you were a serving member of the British military during the 19th century, which role would you have chosen and why?

*ACTIVITY 3/CEMETERIES

The Military in Bermuda in the 20th Century

Bermuda's importance as a naval station was underlined during both World War I and World War II. Before the United States of America entered World War II, the British Government had granted it a free 99 year lease to build military bases in Bermuda. The US Army and the US Navy both began construction of air-stations in 1941. This had the effect of placing much of the responsibility for guarding Bermuda into American hands, freeing British forces to fight the Nazis in Europe.

The Royal Naval Dockyard played a crucial role in assembling convoys of ships taking supplies from America across the Atlantic Ocean to Europe during World War II. These convoys were targeted by German submarines, determined to stop Allied forces being supplied with weapons, food and other essential goods.

After the end of World War II in 1945, the need to protect Bermuda faded. The Royal Naval Dockyard and the military garrison were closed as active bases during the 1950s. The British Government was nearly bankrupt after the war and they could no longer afford to maintain imperial bases, especially after Britain ceased to have such an imperial role and many colonies went independent. A small supply base, HMS *Malabar* continued to operate until it was closed in 1995 along with the American bases.

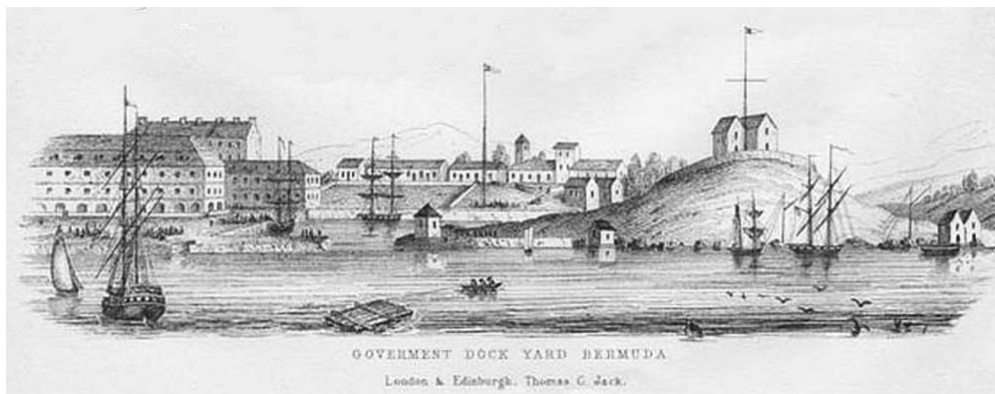

QUESTIONS FOR DISCUSSION

1. Look at the image above. It was produced about 1860 and is an engraving of the Royal Naval Dockyard from the Great Sound. What can you see that interests you?
2. How has the Royal Naval Dockyard changed since then?
3. Today, members of Bermuda's army are made up of men and women who volunteer to serve and men who are conscripted. What does conscription mean? Is conscription fair? How would it feel to be conscripted?

During your visit/Class Field Trip Activities

ST. GEORGE'S MILITARY CEMETERY

/GRENADIER LANE, ST. GEORGE'S

*ACTIVITY 1

Highlighting Soldiers in the British Armed Forces

Students are presented with a selection of activities for investigation during the class field trips.

*ACTIVITY 2

Military Ranks

This activity introduces various military ranks of buried persons in this cemetery.

*ACTIVITY 3

The Children Buried at St. George's Military Cemetery

Observation skills are developed while students investigate the cemetery for graves of children.

ST. PETER'S CHURCH

BURIAL GROUND FOR SLAVES & FREE BLACKS

/YORK STREET, TOWN OF ST. GEORGE'S

*ACTIVITY 1

Highlighting Pilot James Darrell

This activity allows students to learn about slavery and emancipation in Bermuda.

*ACTIVITY 2

Research headstones and inscriptions

Students are introduced to different headstone designs and their meaning.

ROYAL NAVAL CEMETERY/IRELAND ISLAND, SANDY'S

*ACTIVITY 1

Highlighting Soldiers in the British Forces

Students will identify different soldiers of the British Forces.

*ACTIVITY 2

Military and Naval Ranks

This activity will develop observation skills and introduce students to various military and naval ranks.

*ACTIVITY 3

Royal Navy Soldiers & Ships

The activities help the students to search for an important person and men buried that served on Royal Navy ships.

Name: _____

Date: _____



*ACTIVITY 1/CEMETERIES/ST. GEORGE'S MILITARY CEMETERY

Highlighting Soldiers in the British Armed Forces

St. George's Military Cemetery, Grenadier Lane, contains the graves of many different ranks of the British Armed Forces. A cemetery survey completed in 2011 shows 256 memorial sites and the names of 539 individuals appearing on memorials covering an area of about 1.66 acres.

Find three different ranks of soldiers and complete a chart for each grave.

ST. GEORGE'S MILITARY CEMETERY/ GRENADIER LANE, ST. GEORGE'S	
Full name of the deceased	Sketch the shape of the gravestone
Birth Date (if given)	
Death Date	
Age at Death	
Husband/Wife of	
Son/Daughter of	Describe/sketch any other interesting features or unusual features of this gravestone
Military Rank	
Regiment Number (i.e. 1st, 35th)	
Battalion Number (if given)	
Company Name (if given)	
Sketch any symbols on the gravestones	If this is a family grave, make a note of other names, dates and relationships

ST. GEORGE'S MILITARY CEMETERY/ GRENADIER LANE, ST. GEORGE'S	
Full name of the deceased	Sketch the shape of the gravestone
Birth Date (if given)	
Death Date	
Age at Death	
Husband/Wife of	
Son/Daughter of	Describe/sketch any other interesting features or unusual features of this gravestone
Military Rank	
Regiment Number (i.e. 1st, 35th)	
Battalion Number (if given)	
Company Name (if given)	
Sketch any symbols on the gravestones	If this is a family grave, make a note of other names, dates and relationships

*ACTIVITY 2/CEMETERIES/ST. GEORGE'S MILITARY CEMETERY

Military Ranks

Name: _____

Date: _____



The following military ranks can be found in this cemetery.

Use the map of the cemetery to find each grave. Record your findings

PLOT NUMBER	MILITARY RANK	FULL NAME	DATE OF DEATH	AGE AT DEATH
243				
83				
2				
246				
190				
249				
211				
200				
187				
193				
121				
100				

Check off each rank as you find it in the cemetery:

- | | | |
|--|---|---|
| <input type="checkbox"/> Captain | <input type="checkbox"/> Lieutenant | <input type="checkbox"/> Corporal |
| <input type="checkbox"/> Drummer | <input type="checkbox"/> Ensign | <input type="checkbox"/> Gunner and Driver |
| <input type="checkbox"/> Band Sergeant | <input type="checkbox"/> Private | <input type="checkbox"/> Colour Sergeant |
| <input type="checkbox"/> Surgeon | <input type="checkbox"/> Assistant Sergeant Major | <input type="checkbox"/> Assistant Store Keeper |

(See answers in the appendix)

How many graves can you find for each rank of the army? Make a note of your findings.

RANK	PLOT NUMBER/S
Sapper	
Corporal	
Lance Corporal	
Sergeant	
Private	
Captain	
Ensign	
Lieutenant	
Drummer	

*ACTIVITY 3/CEMETERIES/ST. GEORGE'S MILITARY CEMETERY

The Children Buried at St. George's Military Cemetery

Name: _____

Date: _____



This graveyard also contains the graves of many children.

How many can you find?

What is the age of the youngest child buried here? What year did they die?

Find an inscription or epitaph that interests you and copy it into the space below:

CHILDREN BURIED AT ST. GEORGE'S MILITARY CEMETERY	
No. of Children Buried	
Age of the Youngest Child	
Year of Death	
Inscription or Epitaph	

Super Detective



This graveyard contains the grave of someone who died by drowning. Can you find it?

GRAVE NUMBER	FULL NAME	DATE OF DEATH	AGE AT DEATH (IF GIVEN)

This graveyard contains the graves of a surgeon, a doctor, a school master and an assistant shopkeeper. Can you find them?

GRAVE NUMBER	FULL NAME	DATE OF DEATH	PROFESSION
			Surgeon
			Doctor
			School Master
			Assistant Shopkeeper

*ACTIVITY 1/CEMETERIES/ST. PETER'S CHURCH/BURIAL GROUND FOR SLAVES & FREE BLACKS

Name: _____

Date: _____



Highlighting Pilot James Darrell

Walk around the grave yard and locate Pilot Darrell's grave.

1. What is the inscription on his headstone/tablet?

3. Why was Pilot Darrell special?

3. What did he accomplish to be granted freedom?

*ACTIVITY 2/CEMETERIES/ST. PETER'S CHURCH/BURIAL GROUND FOR SLAVES & FREE BLACKS

Research Headstones & Inscriptions

Walk around the graveyard for 10 minutes and look for 5 headstones with male and 5 headstones with female names.

Try to record the inscriptions.

HEADSTONE • MALE		HEADSTONE • FEMALE	
1		1	
2		2	
3		3	
4		4	
5		5	

Walk about the main section of St. Peter's graveyard and look at the headstones. How do they differ in material and inscriptions from the headstones in the burial ground for slaves and free blacks?

*ACTIVITY 1/CEMETERIES/ROYAL NAVAL CEMETERY

Highlighting Soldiers in the British Forces

Name: _____

Date: _____



The Royal Naval Cemetery contains the graves of many different ranks of the British Forces. A cemetery survey completed in 2011 shows 866 graves covering an area of about 2.73 acres.

Find three different ranks of naval officers and complete a chart for each grave.

ROYAL NAVY CEMETERY/ IRELAND ISLAND	
Full name of the deceased	Sketch the shape of the gravestone
Birth Date (if given)	
Death Date	
Age at Death	
Husband/Wife of	
Son/Daughter of	
Military Rank	Describe/sketch any military symbols
Ship (if given)	
Nature of death (if given)	
Inscription or Epitaph	

ROYAL NAVY CEMETERY/ IRELAND ISLAND	
Full name of the deceased	Sketch the shape of the gravestone
Birth Date (if given)	
Death Date	
Age at Death	
Husband/Wife of	
Son/Daughter of	
Military Rank	Describe/sketch any military symbols
Ship (if given)	
Nature of death (if given)	
Inscription or Epitaph	

ROYAL NAVY CEMETERY/ IRELAND ISLAND			
Full name of the deceased	Son/Daughter of	Sketch the shape of the gravestone	Describe/sketch any military symbols
Birth Date (if given)	Military Rank		
Death Date	Ship (if given)		
Age at Death	Nature of death (if given)		
Husband/Wife of	Inscription or Epitaph		

*ACTIVITY 2/CEMETERIES/ROYAL NAVAL CEMETERY

Military & Naval Ranks

Name: _____

Date: _____



The following military ranks can be found in this cemetery.

Use the map of the cemetery to find each grave. Record your findings

PLOT NUMBER	MILITARY RANK	FULL NAME	DATE OF DEATH (IF GIVEN)
2	Able Seaman		
99	Ordinary Seaman		
24	Flight Sergeant		
316	Petty Officer		
515	Shipwright		
177	Rigger		
206	Stoker		
337	Officers Steward		
343	Chief Engineer		
158	Boatswain		

Check off each rank as you find it in the cemetery:

- | | | |
|---|--|-------------------------------------|
| <input type="checkbox"/> Able Seaman | <input type="checkbox"/> Ordinary Seaman | <input type="checkbox"/> Stoker |
| <input type="checkbox"/> Petty Officer | <input type="checkbox"/> Rigger | <input type="checkbox"/> Boatswain |
| <input type="checkbox"/> Officers Steward | <input type="checkbox"/> Chief Engineer | <input type="checkbox"/> Shipwright |

Use a sheet of tracing paper and take a rubbing of a military symbol that interests you.

Many of the memorials list how the individual died. Can you find any of these? Make a note of any inscriptions that you find.

CAUSE OF DEATH	INSCRIPTION

*ACTIVITY 3/CEMETERIES/ROYAL NAVAL CEMETERY

Royal Navy Soldiers & Ships

Name: _____

Date: _____



Find the grave that you think belongs to the most important person buried in this cemetery.

What is the plot number?

What is the person's name and military rank?

Are there any clues about this person's achievements?

Fill in the answers below

PLOT NUMBER	MILITARY RANK	ACHIEVEMENTS

Sketch a picture of this memorial in the space below.



Super Detective



Many of the men buried at the Royal Naval Cemetery served on ships.

How many of the following ships can you find named on the graves?

SHIP	PLOT NUMBER/S
HMS Royal Alfred	
HMS Canada	
HMS Hotspur	
HMS Carnarvon	
HMS Mohawk	
HMS Malabar	
HMS Northampton	
HMS Terror	
HMS Scorpion	
HMS Newcastle	

Can you find the names of any other of Her Majesty's Ships in this cemetery? List them below.

After your visit/Additional Information & Activities

The following activities are designed to consolidate the information gathered during the field trips. They are suggestions for further discussion and brainstorming.

OBJECTIVES

- To review the data gathered during the field trips
- To make comparisons between the cemeteries
- To encourage work in small groups and develop presentation skills

*ACTIVITY 1 Comparison of Cemeteries

This activity will teach students to collate their data and make comparisons between the cemeteries and graves.

*ACTIVITY 2 Visit to the Bermuda National Library

Students will learn how to conduct research in the Bermuda National Library and collect data using archival resources.

*ACTIVITY 3 Class Presentations

Oral presentations using a variety of tools will help students summarize and present data collected on their field trips.

*ACTIVITY 1/CEMETERIES

Comparison of Cemeteries

Students will use their computer skills to collate the data they gathered during their field trips and place information into spreadsheets to look for differences, similarities and social trends. Teachers will guide students to set up spreadsheets and do data analysis using Excel.

The following table is a suggestion for the comparison:

	ST. GEORGE'S MILITARY CEMETERY	BURIAL GROUND FOR SLAVES & FREE BLACKS	ROYAL NAVAL CEMETERY
Location			
Number of graves			
Date of oldest grave			
Date of newest grave			
Unusual names			
Military ranks			

*ACTIVITY 2/CEMETERIES

Visit to the Bermuda National Library

The teacher will organize a field trip to the Bermuda National Library to research a particular person or family history. Students could work in small groups to learn the techniques for archival research. They will attempt to gather information on individuals mentioned in the cemeteries. Findings of the field trip should be compared and discussed during subsequent class work.

RESOURCE - TITLE	DATE	LOCATION IN LIBRARY	ENTRY #	INDIVIDUAL RESEARCHED	NOTES ABOUT INDIVIDUAL

*ACTIVITY 3/CEMETERIES

Class Presentations

Students will work in small groups and prepare short oral presentations on their research about the cemeteries. Groups will each choose one of the three burial grounds visited and highlight the most important findings using PowerPoint presentations, posters with photos. Teachers will encourage class room discussions and reflections on presentation techniques.

*EXTENSION ACTIVITY/CEMETERIES

Royal Naval Cemetery

Name: _____

Date: _____



The Royal Naval Cemetery also contains the graves of a number of civilians (non-military personnel). These graves are largely contained in the central portion of the cemetery. Many of the headstones record how the person died.

Find two civilian graves and record your evidence using the chart below.

ROYAL NAVY CEMETERY /IRELAND ISLAND	
Full name of the deceased	Draw any symbols that you see on the headstone
Birth Date (if given)	
Death Date	
Age at Death	
Family members	Inscription or Epitaph
Manner of death	
Grave number	
Nature of death (if given)	

ROYAL NAVY CEMETERY /IRELAND ISLAND	
Full name of the deceased	Draw any symbols that you see on the headstone
Birth Date (if given)	
Death Date	
Age at Death	
Family members	Inscription or Epitaph
Manner of death	
Grave number	
Nature of death (if given)	

This portion of the cemetery also contains the graves of a large number of children.

How many can you find?

What is the age of the youngest child buried here?

What year did they die?

Find an inscription or epitaph that interests you and copy it into the space below.

ROYAL NAVY CEMETERY /IRELAND ISLAND		
No. of Children Buried	Inscription or Epitaph	Draw any symbols that you see on the headstone
Age of the Youngest Child		
Year of Death		
Age at Death		

St. George's Military Cemetery

Grenadier Lane, St. George's

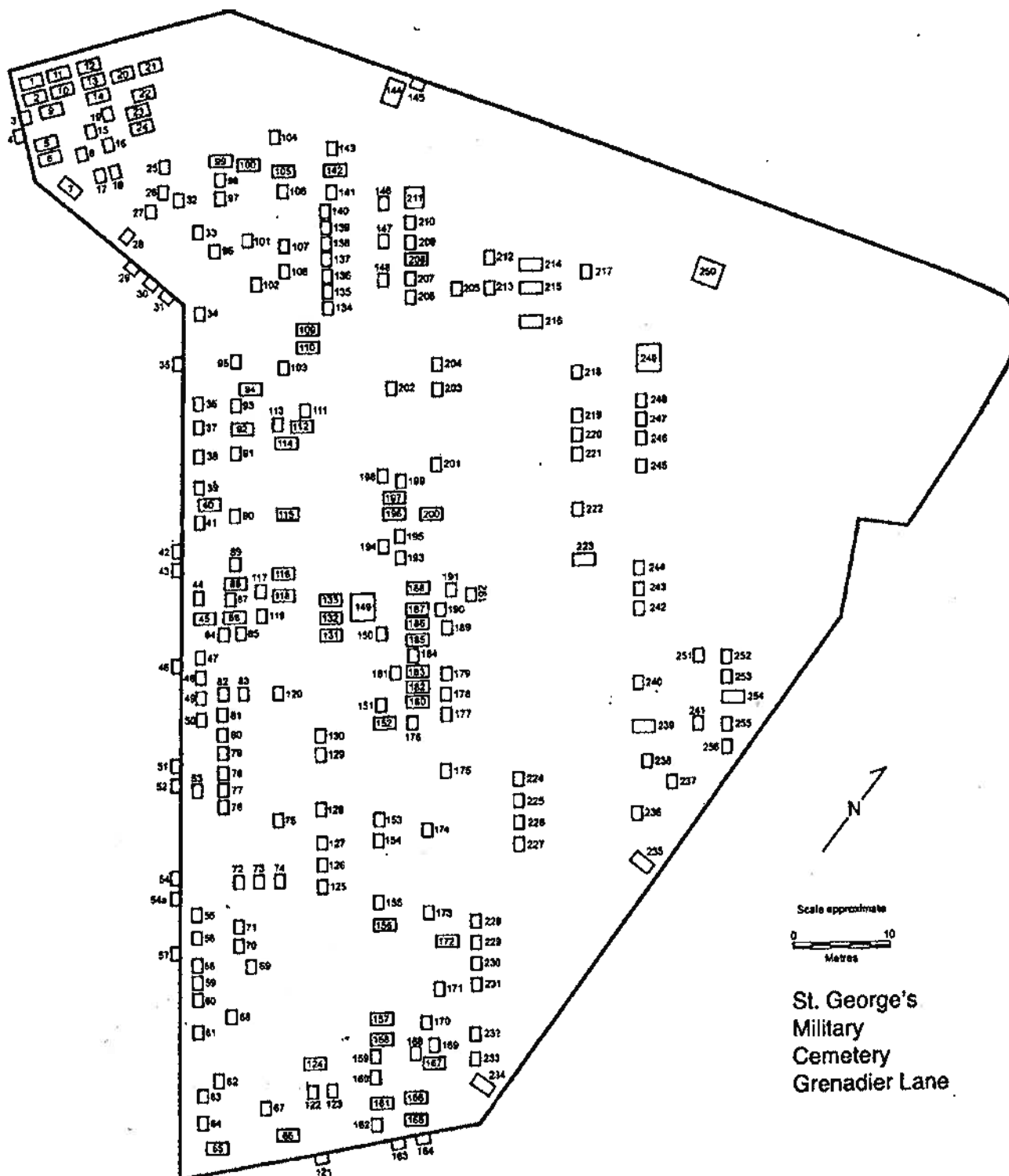

St. Peter's Churchyard St. George's

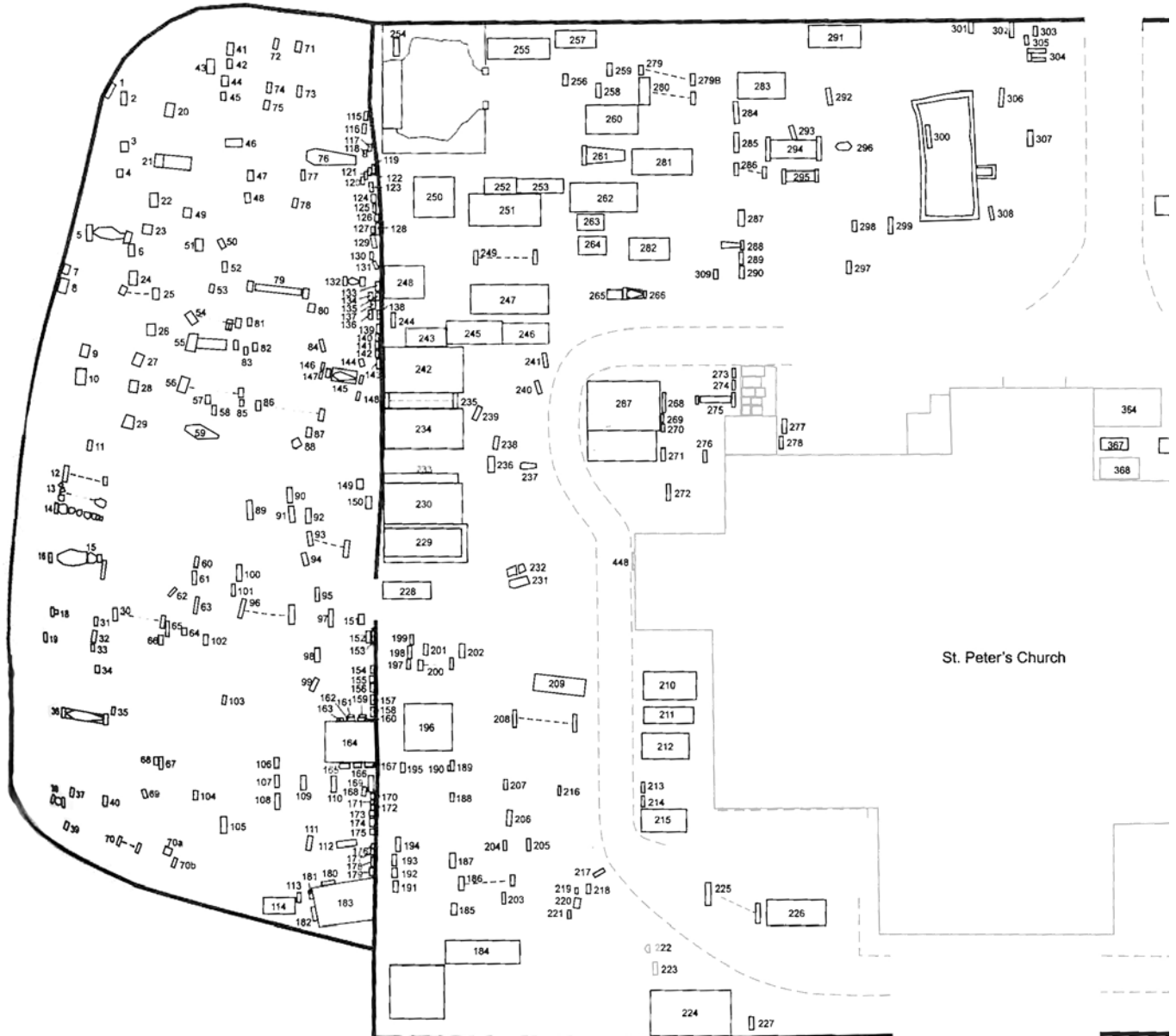

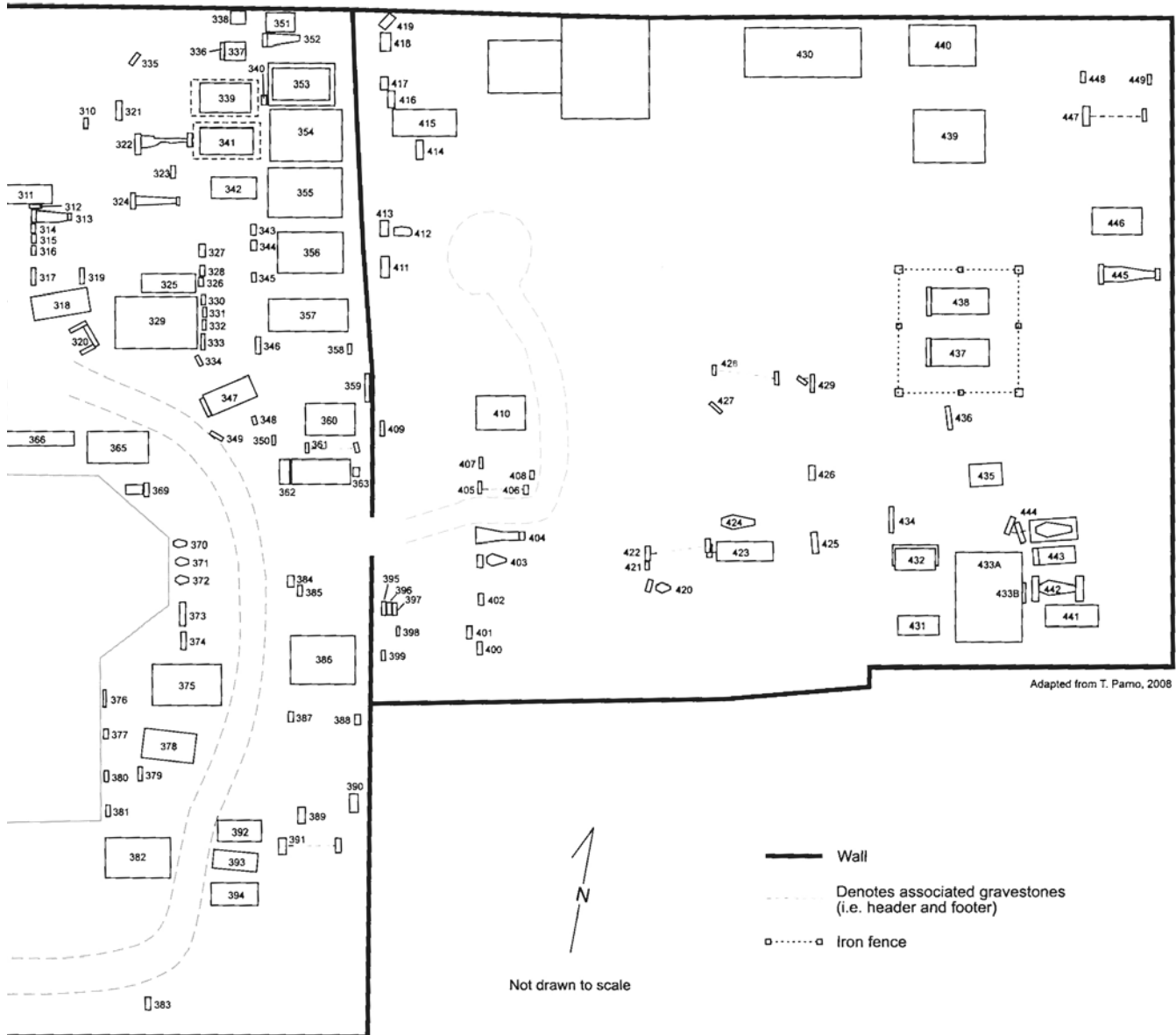

St. Peter's Churchyard St. George's

From "Archaeological Excavations at St. Peter's Church: 2008 Interim Report" by Brent Fortenberry, Richard Lowry, Travis Parno and Sara Ayers-Rigsby (courtesy of the Bermuda National Trust)

Royal Naval Cemetery
Ireland island

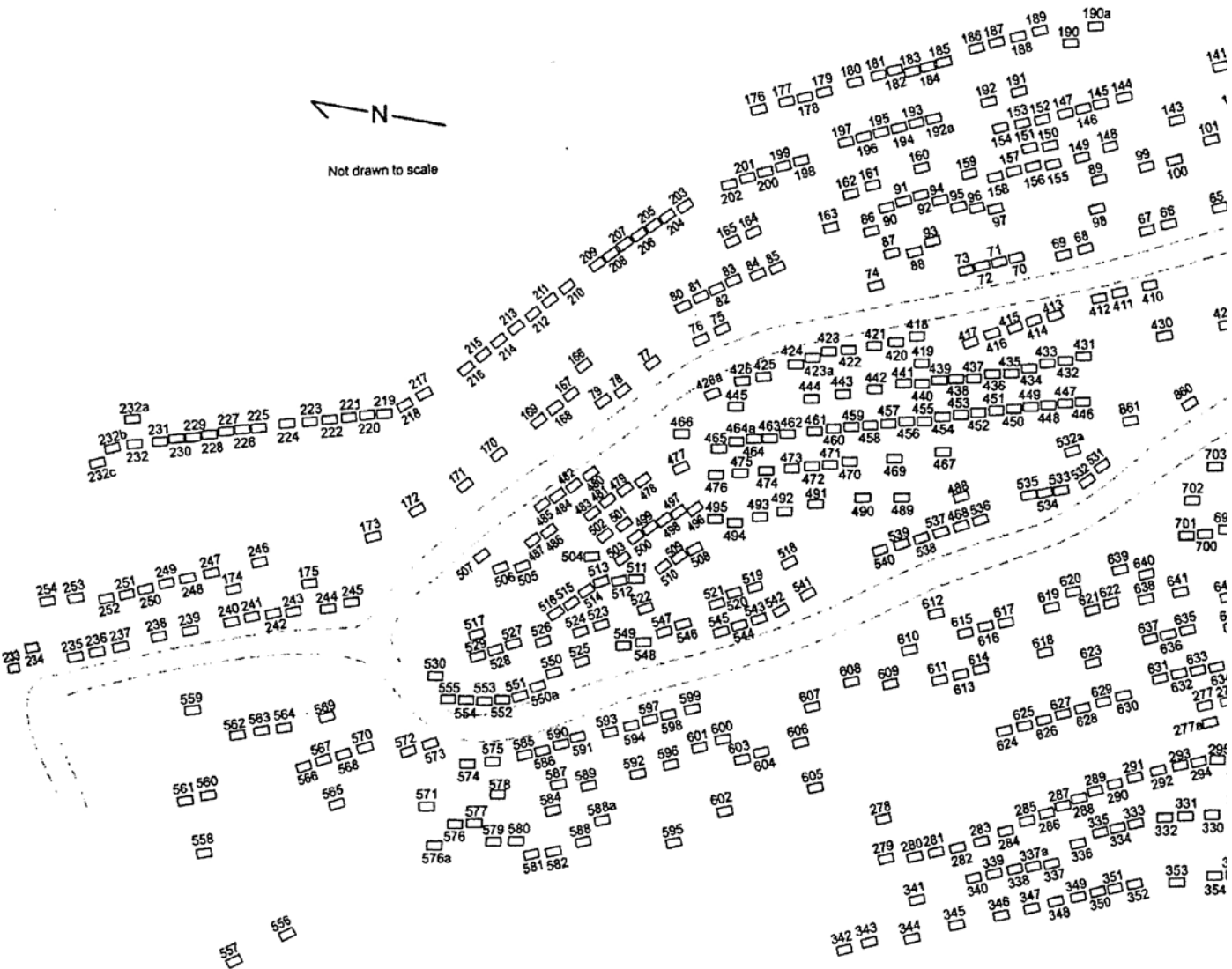

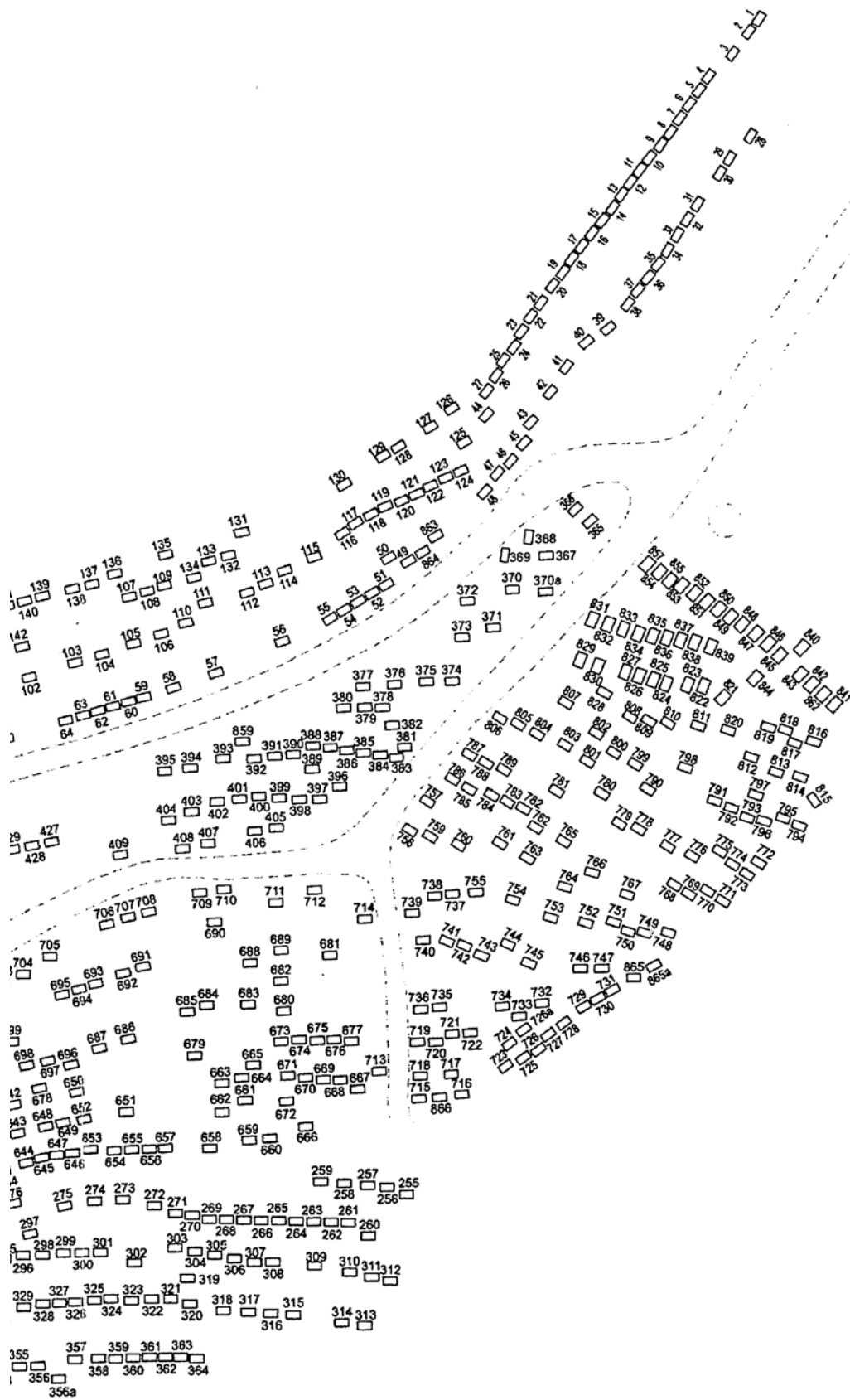

Glossary

Accoutrements: additional items of dress or equipment, or other items carried or worn by a person or used for a particular activity

Cemetery: burial ground. Cemetery comes from the Greek word *koimētērion*, which means “sleeping place”. Cemeteries can often be found near churches, or in big parks outside cities, usually gated off because the ground has been consecrated, or blessed.

Consecrate: dedicated to a sacred purpose

Epitaph: an inscription on or at a tomb or a grave in memory of the one buried there

Headstone: a memorial stone at the head of a grave

Interred: to place (a corpse) in a grave or tomb, typically with funeral rites

Mausoleum: a large tomb, usually a stone building with places for entombment of the dead above ground

Memorial: serving to preserve remembrance

Monument: (1) a lasting evidence, reminder, or example of someone or something notable or great,

(2) a distinguished statue, memorial stone or a building erected in remembrance of a person or event

Plot: a small piece of land in a cemetery

Appendix

Answers page 32:

Activity 2 - St. George's Military Cemetery,
Grenadier Lane, St. George's

RANK	PLOT NUMBER
Captain	246
Drummer	83
Band Sergeant	2
Surgeon	100
Lieutenant	211
Ensign	249
Private	190
Assistant Sergeant Major	200
Corporal	187
Gunner and Driver	121
Colour Sergeant	193
Assistant Store Keeper	243

Historic Cemeteries in Bermuda

Teacher Resources

Activities & Curriculum Links

Before your visit/Introducing Students to Cemeteries in Bermuda

Activity	Grade Level	Subject	Curriculum Link
Activity 1 What is Yellow Fever?	Primary 5	Social Studies	P5 – Explain the sequence and relationship of events. Recognise and understand an increasing number of social studies terms. Organize key ideas related to a topic. Collect supporting evidence from primary and secondary sources.
Activity 2 Military in Bermuda the 19th Century	Primary 6	Social Studies	P6 – Make sequential outline of specific events. Note cause and effect of relationships. Formulate conclusions based on critical examination of relevant information. Evaluate the extent to which global events have affected Bermuda in the past and/or the present (1920-2009).
Activity 3 Military in Bermuda in the 20th Century	Middle 2	Social Studies	M2 – Understand how the economic, political and cultural processes of a country or region influence migration, settlement and relationships between nations. Identify the causes and effects of migration.

During your visit/Class Field Trip Activities

Activity	Grade Level	Subject	Curriculum Link
St. George's Military Cemetery			
Activity 1 Soldiers of the British Armed Forces	Primary 4	Social Studies	P5 – Explain the sequence and relationship of events. Recognise and understand an increasing number of social studies terms. Form a simple organisation of key ideas related to a topic. Collect supporting evidence from primary and secondary sources.
Activity 2 Military Ranks	Primary 5	Social Studies	P6 – Make sequential outline of specific events. Note cause and effect relationships. Formulate conclusions based on critical examination of relevant information. Evaluate the extent to which global events have affected Bermuda in the past and/or the present (1920-2009).
Activity 3 The Children Buried in St. George's Military Cemetery	Middle 1	Social Studies	M2 – RESEARCH AND ANALYSIS: The Town of St. George's: A World Heritage Site <ul style="list-style-type: none"> • Develop skills in library research including archival material • Apply presentation techniques • Use computer skills • Develop and utilise interview skills • Trace the origin, growth and development of the Town of St. George's in Bermuda

During your visit/Class Field Trip Activities

Activity	Grade Level	Subject	Curriculum Link
Burial Ground for Slaves and Free Blacks Activity 1 Highlighting slave Pilot James Darrell Activity 2 Research headstones and inscriptions	Middle 2	Social Studies	M2 – Slavery and Abolition. Describe the system of slavery from its introduction to its abolition in 1834 in the British Empire M2 – RESEARCH AND ANALYSIS: The History of Dockyard or Town of St. George <ul style="list-style-type: none"> • Develop skills in library research including archival material • Apply presentation techniques • Use computer skills • Develop and utilise interview skills • Trace the origin, growth and development of the Dockyard/Town of St. George in Bermuda

During your visit/Class Field Trip Activities

Activity	Grade Level	Subject	Curriculum Link
Royal Naval Cemetery Activity 1 Sailors of the British Naval Forces Activity 2 Military Ranks	Primary 5 Primary 6	Social Studies Social Studies	P5 – Explain the sequence and relationship of events. Recognise and understand an increasing number of social studies terms. Organize key ideas related to a topic. Collect supporting evidence from primary and secondary sources. P6 – Make sequential outline of specific events. Note cause and effect relationships. Formulate conclusions based on critical examination of relevant information. Evaluate the extent to which global events have affected Bermuda in the past and/or the present (1920-2009).
Activity 3 Royal Navy Soldiers & Ships	Middle 2	Social Studies	M2 – RESEARCH AND ANALYSIS: The History of Dockyard <ul style="list-style-type: none"> • Develop skills in library research including archival material • Apply presentation techniques • Use computer skills • Develop and utilise interview skills • Trace the origin, growth and development of the Dockyard

After your visit/Additional Information & Activities

Activity	Grade Level	Subject	Curriculum Link
Activity 1 Collating data, looking for social trends	Primary 5	Social Studies	P5 – Explain the global connections on the tiered time line using dates and vocabulary relating to their interconnectedness. Explain the sequence and relationships of events. Form a simple organization of key ideas related to a topic. Identify major personalities of the time period and evaluate the importance of their actions.
Activity 2 Research the design of headstones and the symbols	Primary 6	Social Studies	P6 – Make sequential outline of specific events. Note cause and effect relationships. Formulate conclusions based on critical examination of relevant information. Evaluate the extent to which global events have affected Bermuda in the past and/or the present (1920-2009). Identify major personalities of the time period and evaluate the importance of their actions then and now.
Activity 3 Research the history of a particular ship			
Activity 4 Research navy ranks, symbols	Middle 2	Social Studies	M2 – RESEARCH AND ANALYSIS: The History of Dockyard or Town of St. George
Activity 5 Research navy awards and decorations			<ul style="list-style-type: none"> • Develop skills in library research including archival material • Apply presentation techniques • Use computer skills • Develop and utilise interview skills • Trace the origin, growth and development of the Dockyard/Town of St. George in Bermuda
Activity 6 Research a particular person or family history			
Activity 7 Presentations			

References

Held in Trust: The Properties and Collections of the Bermuda National Trust. Hamilton, Bermuda: Bermuda National Trust, 2008. Print.

Tulloch, H. R., and R. C. Tulloch. *Bermuda Memorial Inscriptions.* [Bermuda]: National Museum of Bermuda, 2011. Print.

www.bnl.bm/files/2011/08/Bermuda_History_Epidemics.pdf



THE BERMUDA NATIONAL TRUST

To protect and promote Bermuda's unique natural and cultural heritage forever.



School Field Trip Booking Form

Please complete this form, scan and return via email to education@bnt.bm or fax it to: 236-0617

A member of our Education Team will be in touch with you to schedule your field trip. Thank you for contacting the Bermuda National Trust Axis Education Programme.

BNT site requested		
Date requested: Please provide 2 options	1.	2.
Contact person (full name)		
Time requested		
Phone	work	cell
Email		
School		
Year level		
Number of students		
Number of adults: Ratio for school field trips is 1 adult for every 10 students (additional adults are welcome)		
Are there students with learning/ physical difficulties? Please describe.		
Teaching objectives		
Ties with curriculum		
Please answer the following: How did you hear about school field trips and resources provided by BNT?		
Are you interested in attending workshops to learn more about our nature reserves and historical homes? If so, please indicate which sites.		

Kindly sponsored by AXIS Capital Holdings Limited



THE BERMUDA NATIONAL TRUST

To protect and promote Bermuda's unique natural and cultural heritage forever.



School Field Trip Permission Form

Please complete this form, scan and return via email to education@bnt.bm
or fax it to: 236-0617

School Name:

Dear Parents,

Our class will be participating in a field trip to:

Our trip is scheduled for date: time:

PARENT/GUARDIAN PLEASE FILL OUT THE BELOW FORM AND SIGN

I, give my permission for (student's name)

to attend the trip to the Bermuda National Trust property indicated above. Please note that the Bermuda National Trust staff may take photos of individuals attending our field trips and activities, which may be featured in their publications. In signing this form I give consent for my son/daughter to be featured in BNT publications.

.....
Parent/Guardian

.....
Date

Kindly sponsored by AXIS Capital Holdings Limited